



## Model 648PRO Side-by-Side Refrigerator/Freezer

Born of 100% steel (and a good bit of bravado), the Model 648PRO is a true masterpiece of preservation. Its sculpted metal, dual refrigeration with three evaporators and advanced controls marry performance and design in a bold new way for home refrigeration. So it not only keeps foods magnificently fresh, it brings the whole kitchen tastefully up to date. Model 648PRO can be built-in or used in a free-standing application.



Model 648PRO shown in a free-standing application.

### Features

- Stainless steel construction—inside and out—with classic stainless finish
- Dual refrigeration system
- Electronic digital controls with exterior temperature display
- Advanced interior lighting with channeled sidewall LEDs
- Cantilevered shelves are adjustable and spill-proof
- Slide-out stainless steel bins fit neatly under any shelf
- Touch-and-glide crisper drawer has a glass lid and generous humidity
- Adjustable, removable and interchangeable drawer dividers
- Auto-close advanced hinge system
- Door alarm
- Automatic ice maker with water filtration system
- Meets strict Department of Energy requirements



Slide-Out Bins



Glass Crisper Lid

### Model

Stainless Steel Finish

### 648PRO

Classic

### Interior Features

- **Refrigerator (door and two drawers)**
  - 3 Adjustable Glass Shelves
  - 1 Stationary Glass Shelf
  - 2 Adjustable Stainless Steel Slide-Out Bins
  - 1 Glass Crisper Lid
  - Interchangeable Drawer Dividers
- **Freezer (door and two drawers)**
  - Automatic Ice Maker
  - Water Filtration Filter
  - 3 Adjustable Stainless Steel Shelves
  - 1 Stationary Stainless Steel Shelf
  - Stainless Steel Ice Bucket
- Exterior Temperature Display
- Auto-Close Advanced Hinge System

### Accessories

- 90 degree door stop kit—right or left hinge
- Dozen egg container with lid
- Slide-out refrigerator bin
- Classic stainless steel side panel
- Free-standing kit—includes two classic stainless steel side panels and top lid
- Refrigerator drawer dividers
- Classic stainless steel front and side toe kicks

Accessories are available through your Sub-Zero dealer. To obtain local dealer information, visit the Locator section of our website, [subzero.com](http://subzero.com).



This appliance is certified by Star-K to meet strict religious regulations in conjunction with specific instructions found on [www.star-k.org](http://www.star-k.org).





**Model 648PRO**  
Side-by-Side Refrigerator/Freezer

**Overall Dimensions**

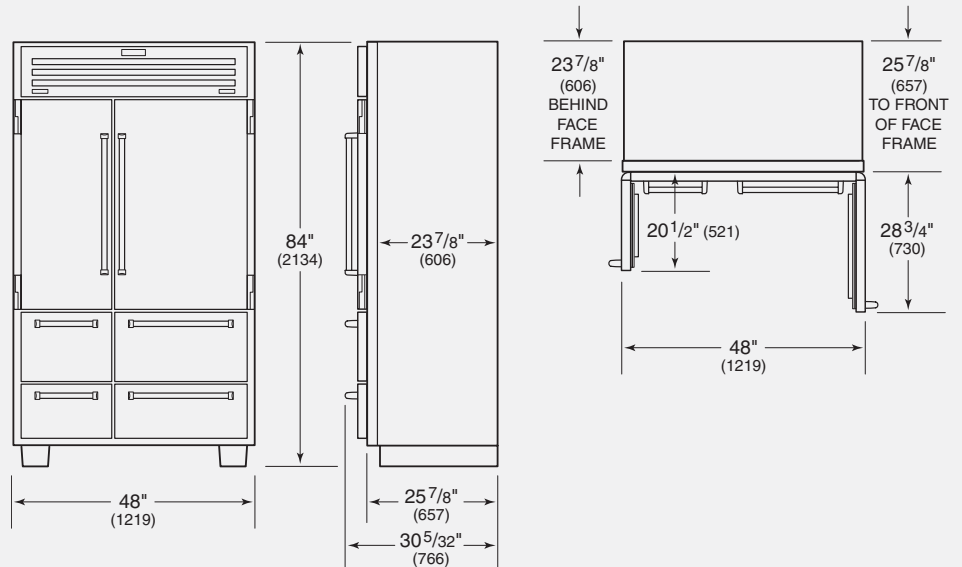

Unit dimensions may vary by  $\pm 1/8"$ .

**Specifications**

Overall Width	48"
Overall Height	84"
Overall Depth (behind face frame)	23 7/8"
(to front of face frame)	25 7/8"
Door Swing Clearance	28 3/4"
Refrigerator Capacity	18.4 cu ft
Freezer Capacity	11.7 cu ft
Finished Opening (standard)	47 1/2" W x 83 3/4" H x 24" D
(flush)	48" W x 84 1/8" H x 26" D
Minimum Height Required	83 1/2"
Electrical Requirements	115 V AC, 60 Hz 15 amp dedicated circuit
Plumbing Requirements	1/4" OD copper line 35-120 psi
Annual Energy Usage	\$63*
Shipping Weight	860 lbs

\*Based on 9.06 cents per kilowatt hour.

**Installation Notes**

Model 648PRO can be used free-standing or installed as a standard or flush built-in application. For standard built-in installations, the face frame of the unit will extend 2" beyond cabinetry. In flush built-in installations, the front of the face frame will be flush with surrounding cabinetry.

Complete installation specifications, including panel sizes, can be found on our website, [subzero.com](http://subzero.com).

**Installation Specifications**

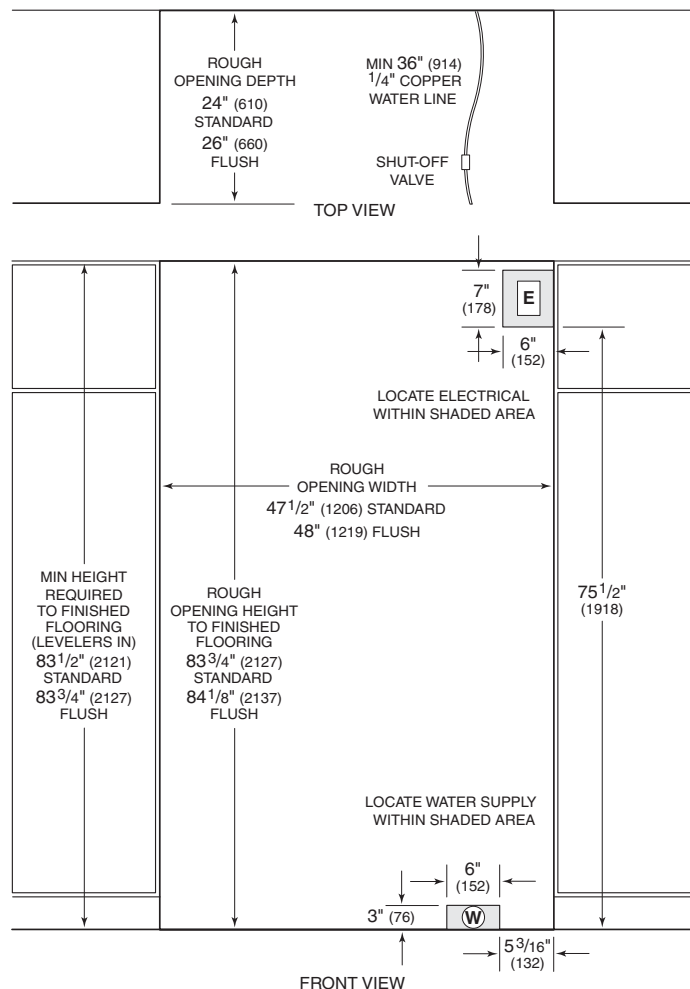

Dimensions in parentheses are in millimeters unless otherwise specified.